

SAMSUNG SHP-DP728 簡易功用說明

門外

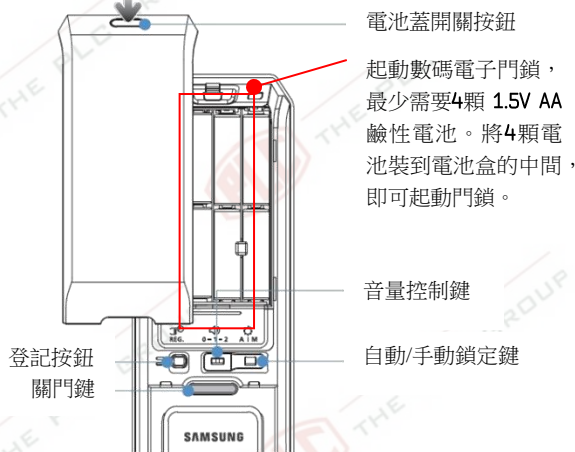

門內



< 指紋感應區放置手指的方法 >

正確



將手指放入指紋感應區中央位置

錯誤



劇烈晃動手指



手指偏向一側



手指置於感應區外



手指放入過多

No.	名稱	功用說明
1	9V緊急電源接口	當電池用完時，接入應急用電池，即可接通電源。（使用9V鹼性電池）
2	感應卡讀頭	持卡接近感應卡讀頭，迷你卡應保持在20mm以內，RF卡應保持在10mm以內。不同製造商生產的電子卡的感應距離可能有所不同。
3	電池	電池因製造廠家、製造日期、使用環境不同，使用壽命會稍有差異。8顆1.5V AA型鹼性電池，按1天使用10次為例，大約可用12個月。請勿混合不同品牌的電池，混合不同品牌的電池會影響數碼電子門鎖性能。為避免電池液體洩漏時會損壞鎖體，請務必定期（約6個月間隔）進行確認或更換。
4	機械鎖匙位	門外鎖體下面有緊急機械鎖匙位。插入機械鎖匙後左右旋轉，即可開門。
5	註冊卡及密碼注意事項	設定密碼可註冊最多20張卡，包括Key Tag 及使用者密碼。 改動門鎖設置，例如：設定新用戶密碼、匙牌/卡，需輸入主用戶密碼。
6	"sHome Doorlock (智能門鎖)" 應用程式	1個門鎖可以登記8部手機；1部手機可以登記3個門鎖。（門鎖名稱與用戶名稱不可相同。） 3大功能：●藍牙開門；●進出記錄及訊息提示；●隨時查看最近30次進出記錄。 若遺失手機：●初始化智能門鎖及重置應用程式；●可在其他用戶的手提裝置應用程式內直接刪除丟失手機的用戶。 支援藍牙4.0或以上；iOS 7.1以上，Android 4.3或以上版本的手提裝置。（詳情請瀏覽： www.samsungsds.com.cn ） （應用程式的穩定性和效果，視乎用戶手提裝置的牌子、型號、系統版本、性能、網絡數據素質和配合度而有所不同。）



SAMSUNG原廠感應保養卡 - PLC保養服務包括：

- 服務查詢
- 配匙服務
- 鎖體更換服務

DISCLAIMER: All information are subjected to change at anytime without prior notice by The PLC Group or its associated partners/suppliers. Should there be any variations in product functionality, outlook, technical specifications, documentation, service, warranty, promotions and/or pricing, the actual offering at the time of purchase shall be the confirmed version.

The catalog information is for reference only. For updated details, please contact The PLC Group.
In case of dispute, The PLC Group reserves the right to final decision.
If there is any inconsistency of conflict between English and Chinese version, the English version shall prevail.

Samsung SMART Doorlock names and logos are registered trademarks and properties of SAMSUNG SDS CO. LTD., any use without prior written consent is prohibited. Copyright©2016 All rights reserved.

SAMSUNG SHP-DP728 QUICK GUIDE

Outer Body



Inner Body

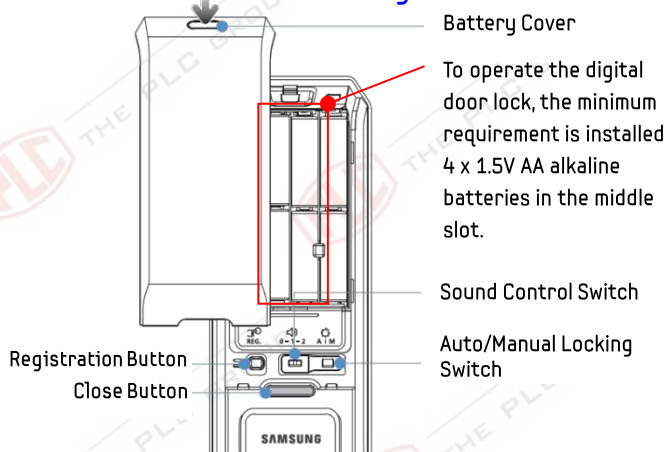

< How To Place Finger On The Panel >

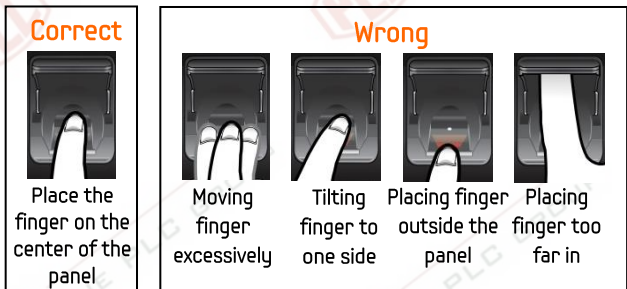

No.	Name	Description
1	9V Emergency Power Port	Power can be supplied from the emergency battery after the main batteries have been completely discharged (9V alkaline battery).
2	RF Card Reader	The RF card reader will operate properly when a key tag and a RF card are placed within 20mm and within 10mm of the card reader. The recognition distance may differ depending on the card manufacturer.
3	Battery	Although actual battery life differs depending on the manufacturer, date of production and operation environment, 8 x 1.5V AA alkaline batteries can last for one year, based on an average of 10 uses per day. Don't mix the batteries of the different brand, because it will affect the lock performance. Liquid leaks from batteries can damage the product. Check/replace the batteries regularly (every 6 months).
4	Mechanical Override Key Hole	A mechanical override key hole is located at the bottom of the outer body. Insert the key into the key hole and rotate it to the right or left to lock or unlock.
5	Registration Tips	The master password can register and use up to 20 cards, including key tag & user password. Master password is required when changing the lock settings or user registrations (e.g. access codes, RF tag/card).
6	"sHome Doorlock" APP	A doorlock can be paired with up to 8 smartphones; a smartphone compatible with up to 3 doorlocks. (Doorlock names and user names can not be the same.) 3 functions: ❶ Bluetooth unlock; ❷ Instant access notification; ❸ In & out record. (Up to 30 records) In case of losing your mobile phone: ❶ initialize the smart doorlock and reset the "sHome Doorlock" App; ❷ delete the user in another users' smartphone. Only smartphone with bluetooth version 4.0 or above, iOS 7.1/ Android 4.3 or higher support this function. (To check the compatibility of your phone, please refer to our: www.samsungsds-nss.com/en) (The "sHome Doorlock" App and bluetooth pairing may not function properly depending on the environment, network provider, network conditions and signal quality, the model and brand and the system version of your smartphones.)



1-Year Installation Warranty



2-Year Product Warranty



Samsung RF Warranty Card - PLC Warranty Services:
- Service Enquiries
- Key Duplication
- Cylinder Replacement Orders

DISCLAIMER: All information are subjected to change at anytime without prior notice by The PLC Group or its associated partners/suppliers. Should there be any variations in product functionality, outlook, technical specifications, documentation, service, warranty, promotions and/or pricing, the actual offering at the time of purchase shall be the confirmed version.

The catalog information is for reference only. For updated details, please contact The PLC Group.
In case of dispute, The PLC Group reserves the right to final decision.
If there is any inconsistency of conflict between English and Chinese version, the English version shall prevail.

Samsung SMART Doorlock names and logos are registered trademarks and properties of SAMSUNG SDS CO. LTD., any use without prior written consent is prohibited. Copyright©2016 All rights reserved.



(EXCLUSIVE DISTRIBUTOR for Hong Kong & Macau 香港及澳門獨家總代理)
Head office: Unit A-D 9/F Gemstar Tower 23 Man Lok Street Hung Hom Kowloon Hong Kong
辦公室: 香港九龍紅磡民樂街23號駿昇中心9樓A-D座
客戶服務熱線 Customer Service Hotline: 2765 9667 傳真 Fax: 2330 2082 電郵 Email: plc@plc.com.hk 網址 Website: www.plc.com.hk
SAM-SHP-DP728QGV1.0